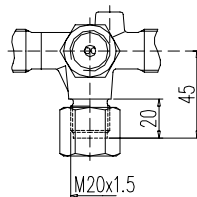
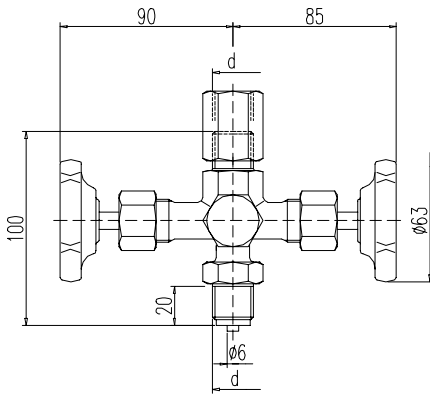
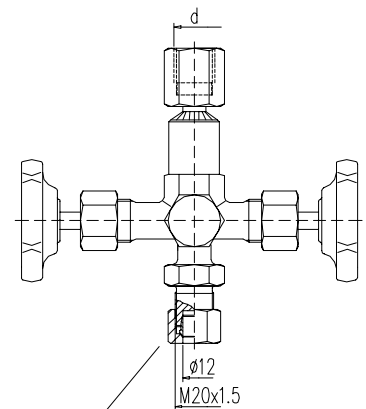
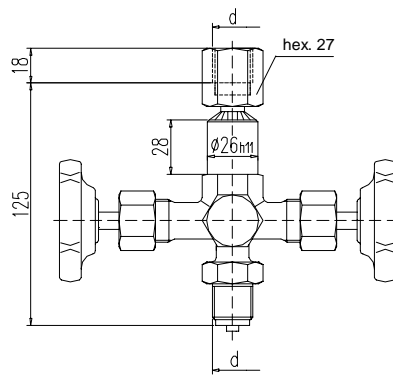

**Design A**

 with adjusting nut  
DIN 16 283

**Design B**

 with swivel nut and shaft for  
pressure gauge support

 tube fitting  
O. D. 12 mm  
line S

**Please note:** Pressure gauge valves with thread 1/2 NPT  
see catalogue page 9.27

**MOUNTING ACCESSORIES see section 10**

PN <sup>3)</sup>	Connection thread d	Material	Part no.		
			Design A	Design B	Design B-AS12
250	G 1/2	brass	S004.60.000	S004.60.020	S004.60.020.13
400		steel	S004.60.100	S004.60.120	S004.60.120.13
400		st. st.	S004.60.200	S004.60.220	S004.60.220.13
250	M 20x1,5	brass	S004.60.050	-	-
400		steel	S004.60.150	-	-
400		st. st.	S004.60.250	-	-

Components	Brass <sup>1)</sup>	Steel	Stainless steel <sup>1)</sup>
	DIN - Material Number		
Body <sup>2)</sup>	brass	1.0460	1.4571
Valve stem	1.4104		1.4571
Needle tip	1.4104		1.4571
Packing	PTFE up to 200°C (graphite up to 250°C)		
Union nut	steel	stainless steel	
Adjusting nut	steel		stainless steel
Swivel nut	brass	steel	stainless steel
Handwheel	plastic		

Abbreviation acc. to DIN	Material	Temperature rating
10 Ms	brass	- 10 up to + 120°C
10 St	steel	- 10 up to + 120°C
20 St	stainless steel	- 20 up to + 200/250°C

- **Body:** brass: pressed part  
steel / stainless steel: die-pressed part

- **Surface:** steel phosphatized

- Internal stem thread

- Stem with cold rolled surface and non-rotating needle tip

1) Can also be supplied for oxygen service.

Please notice order instruction B 3!

2) Available with inspection certificate 3.1  
acc. to EN 10 204

3) Valves with PN 640 on request