

# MARINE PRESSURE TRANSMITTER

New generation available - refer to [www.trafag.com/H72322](http://www.trafag.com/H72322)

Swiss based Trafag is a leading international supplier of high quality sensors and monitoring instruments for measurement of pressure and temperature.



## Applications

- Shipbuilding
- Engine manufacturing

## Features

- Economical
- Good media compatibility
- EMC protection, IEC 61000
- Absolute or relative pressure measurement

## Technical Data

Measuring principle	Thick film on ceramic	Media temperature	<60 bar: -25°C ... +85°C >60 bar: -10°C ... +85°C
Measuring range	0 ... 1 to 0 ... 250 bar	Ambient temperature	-25°C ... +85°C
Output signal	4 ... 20 mA	Approval / conformity	BV, DNV, GL, KRS, LRS, NKK
Accuracy @ 25°C typ.	± 0.5 % FS typ.		

11/2016

Data sheet H72239g

Subject to change

## Ordering information/type code

					8498 . XX	XX	XX	XX	XX	XX
<b>Measuring range <sup>1)</sup></b>	<b>Pressure measurement range [bar]</b>	<b>Over pressure [bar]</b>	<b>Burst pressure [bar]</b>							
	0 ... 1.0	4	5		71					
	0 ... 1.6	4	5		73					
	0 ... 2.5	6	7.5		75					
	0 ... 4	10	12		76					
	0 ... 6	15	18		77					
	0 ... 10	25	30		78					
	0 ... 16	40	48		79					
	0 ... 25	60	75		80					
	0 ... 40	80	120		81					
	0 ... 60	120	180		82					
	0 ... 100	200	300		83					
	0 ... 160	320	480		85					
0 ... 250	500	750		74						
<b>Sensor</b>	relative (Pressure connection: 1.4435)									29
	absolute (Pressure connection: 1.4435)									49
<b>Pressure connection</b>	G1/4" female									10
	G1/4" male (Seal)									17
	1/4" NPT male									30
	7/16"-20UNF male, DIN3866									18
	7/16"-20UNF female, DIN3866 (valve opener)									24
<b>Electrical connection</b>	Male electrical plug: DIN43650-A, Mat.: PA									04
<b>Output</b>	<b>Output</b>	<b>Load resistance</b>	<b>I (supply)</b>	<b>U (supply)</b>						
	4 ... 20mA	(U <sub>supply</sub> -9V) / 20mA		9 ... 32 VDC						29
<b>Accessories</b>	Seal FKM									61
	Seal CR									62
	Seal EPDM									63
	Pressure peak damping element ø 0.3 mm									43
	Pressure peak damping element ø 0.5 mm									45
	Pressure peak damping element ø 1.0 mm									40
	Female electrical connector EN 175301-803-A (DIN43650-A)									

<sup>1)</sup> Customized pressure ranges upon request

## Standard products (extra short lead time)

Product No.	Type Code	Pressure range [bar]	Over pressure max. [bar]	Supply [VDC]	Accuracy @ 25°C typ. [%]
ECON4.0A	8498 76 2917 04 0000 0000 29 58 61	0...4	10	9...32	±0.5
ECON6.0A	8498 77 2917 04 0000 0000 29 58 61	0...6	15	9...32	±0.5
ECON10.0A	8498 78 2917 04 0000 0000 29 58 61	0...10	25	9...32	±0.5
ECON16.0A	8498 79 2917 04 0000 0000 29 58 61	0...16	40	9...32	±0.5
ECON40.0A	8498 81 2917 04 0000 0000 29 58 61	0...40	80	9...32	±0.5

Specifications		
<b>Accuracy</b>	TEB typ. @ -25 ... +85°C	± 3.0 % FS typ.
	Accuracy @ 25°C typ.	± 0.5 % FS typ.
	NLH @ 25°C (BSL) typ.	≤ 160 bar: ± 0.3 % FS typ. > 160 bar: ± 0.5 % FS typ.
	TC zero point and span typ.	± 0.03 % FS/K typ.
	Long term stability 1 year typ.	± 0.3 % FS typ.
<b>Electrical Data</b>	Output / supply voltage	4 ... 20 mA; 24 (9...32)VDC
	Rise time	typ. 1 ms/ 10...90 % Nominal pressure
<b>Environmental conditions</b>	Media temperature	<60 bar: -25°C ... +85°C >60 bar: -10°C ... +85°C
	Ambient temperature	-25°C ... +85°C
	Protection <sup>1)</sup>	Min. IP65
	Humidity	max. 95 % relative
	Vibration	4g (10...2000 Hz)
	Shock	50g/ 11 ms
<b>EMC Protection</b>	Emission	EN/IEC 61000-6-3
	Immunity	EN/IEC 61000-6-2
<b>Mechanical Data</b>	Sensor (wetted parts)	Ceramic, Al <sub>2</sub> O <sub>3</sub> (96 %)
	Pressure connection (wetted parts)	1.4404 (AISI316L)
	Housing	1.4404 (AISI316L)
	Sealing	FKM 70 Sh, CR, EPDM
	Male electrical plug	See ordering information
	Weight	~ 110 g
	Mounting torque	15...20 Nm

<sup>1)</sup> See electrical connection

Additional information		
<b>Documents</b>	Data sheet	<a href="http://www.trafag.com/H72239">www.trafag.com/H72239</a>
	Instructions	<a href="http://www.trafag.com/H73212">www.trafag.com/H73212</a>
	Flyer	<a href="http://www.trafag.com/H70680">www.trafag.com/H70680</a>

## Dimensions

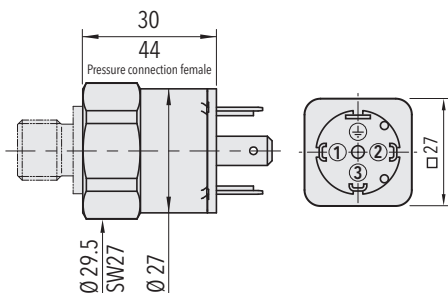

8498.XX.XXXX.04.XX.XX

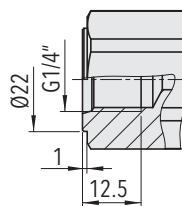

8498.XX.XX10.XX.XX.XX

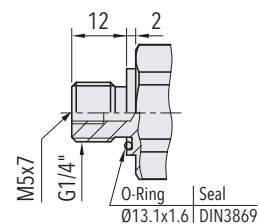

8498.XX.XX17.XX.XX.XX

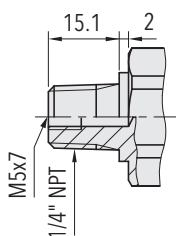

8498.XX.XX30.XX.XX.XX

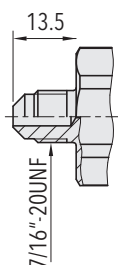

8498.XX.XX18.XX.XX.XX

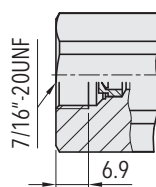

8498.XX.XX24.XX.XX.XX

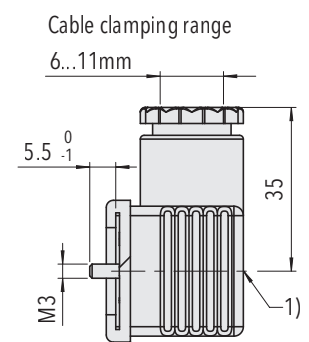

8498.XX.XXXX.XX.XX.58

## Electrical connection

		Protection / electrical connection	
		IP65*)	
		Industrial standard EN175301-803A	
		<b>04</b> 	
Output signal		2	
	<b>8498.XX.XXXX.XX.29</b>	1	⊕

\*) Provided female connector is mounted according to instructions